

Notes

This drawing is copyright and owned by Bailey Partnership, and is for use on this project and site only unless contractually stated otherwise.

DO NOT SCALE this drawing (printed or electronic versions). Contractors must check all dimensions from site.

All other design team elements, where indicated, have been imported from the consultant's drawings and reference should be made to the individual consultant's drawings for exact setting out, size and type of component.

Discrepancies and / or ambiguities within this drawing, between it and information given elsewhere, must be reported immediately to the architect for clarification before proceeding.

All works are to be carried out in accordance with the latest British Standards and Codes of Practice unless specifically directed otherwise in the specification.

Responsibility for the reproduction of this drawing in paper form, or if issued in electronic format, lies with the recipient to check that all information has been replicated in full and is correct when compared to the original paper or electronic image. Graphical representations of equipment on this drawing have been co-ordinated, but are approximations only. Please refer to the Specifications and / or Details for actual sizes and / or specific contractor construction information. Ordnance Survey Paper Map Copying License number: 40006119

This original document is issued for the purpose indicated below and contains information of confidential nature. Further copies and circulation will be strictly in accordance with the confidentiality agreement under the contract.

SAFETY, HEALTH AND ENVIRONMENTAL INFORMATION

Refer to the relevant Construction (Design and Management) documentation where applicable.

It is assumed that all works on this drawing will be carried out by a competent contractor, working where appropriate to an approved method statement.

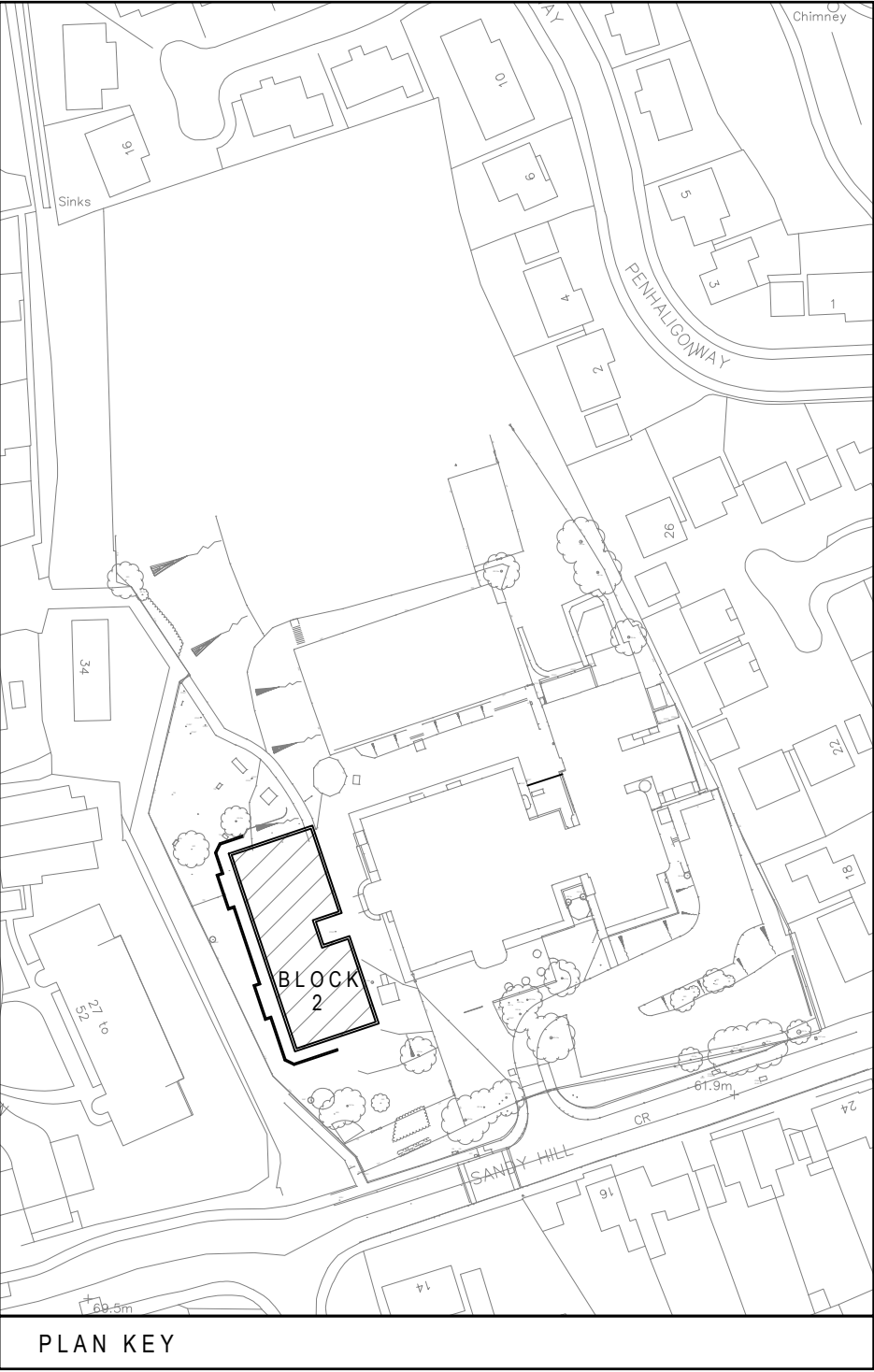
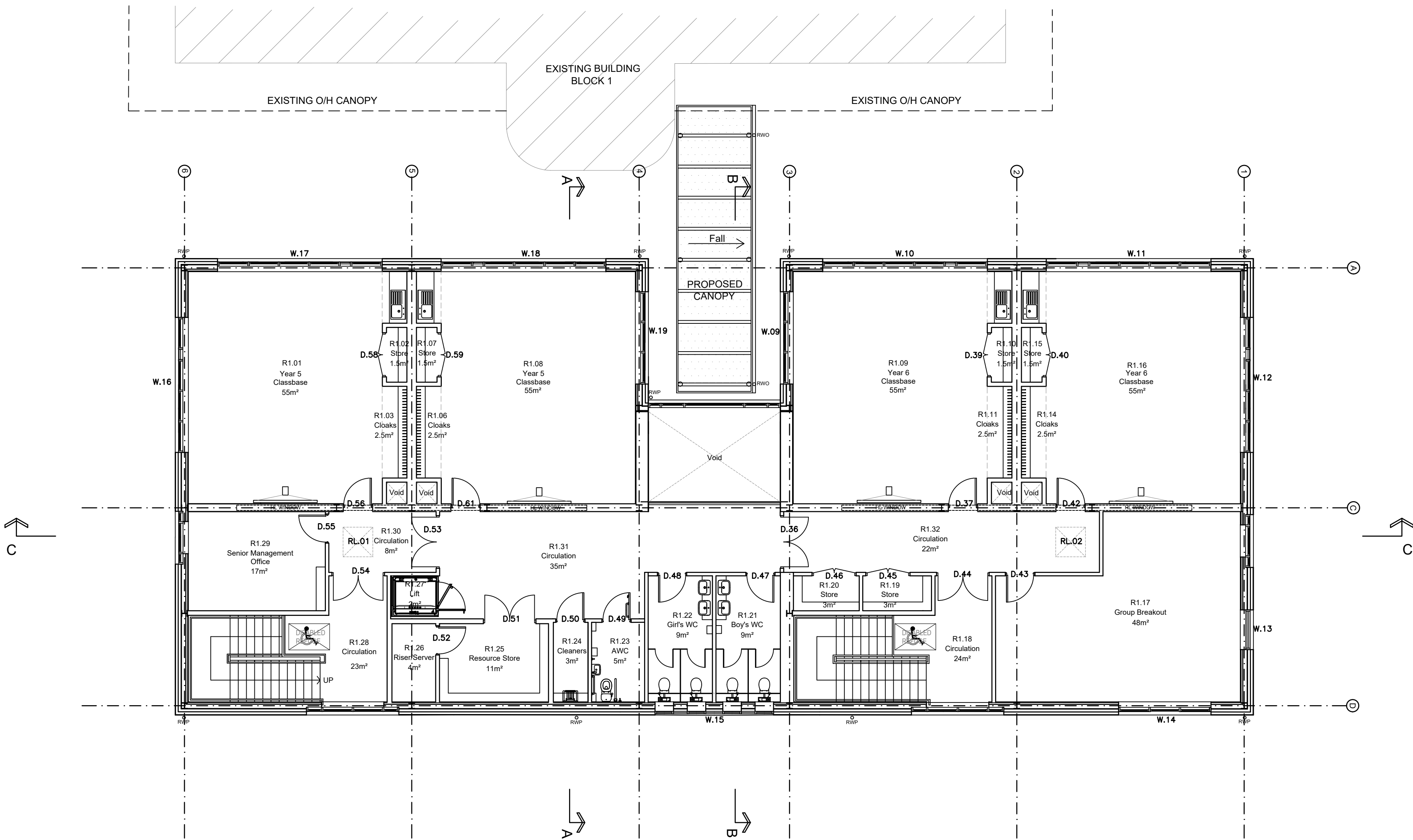

C1 Contractors Proposal - For Construction	NM/SJC/SJC	17.03.17
C0 Contractors Proposal-Preliminary Issue	CNM/SJC/SJC	21.11.16
T0 First Issue	CNM	SJC 27.09.16
Rev	Description	/ By / Chkd / App'd Date

baileypartnership
CONSTRUCTION AND PROPERTY CONSULTANTS
www.baileypartnership.co.uk

Client
Kier Construction

Project
**Sandy Hill Academy
Sandy Hill, St Austell,
Cornwall, PL25 3AT**

Drawing Title
**Block 2
Proposed GA Plans
First Floor Plan**

Purpose of Issue Contractors Proposals		Status S2	
Project No. 28206	Scale @ A1 1:100	Date 21.11.16	
Revision C1	Drawn CNM	Checked SJC	Approved SJC

A1 Drawing Identifier				BS1192:2007 / Avanti Compliant			
project	zone	level	file type	role	number		
SHA	BP	02	01	DR	A	061002	